

GLASS TYPES

- G1 - 1" INSULATING, BOTH PANES TEMPERED
- G2 - 1" INSULATING, LAMINATED
- G3 - 1/4" CLEAR GLASS
- G4 - 1/4" CLEAR TEMPERED GLASS
- G5 - 1/4" CLEAR SAFETY WIRE GLASS
- G6 - 1" INSULATING W/ SPANDREL, BOTH PANES TEMPERED

WINDOW LEGEND



TOWN CREEK MIDDLE SCHOOL

6370 LAKE PARK DRIVE
SE
WINNABOW, NC 28479

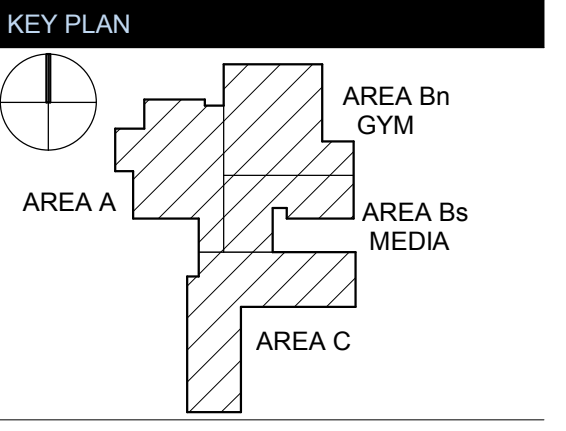

REVISIONS

No.	Description	Date
1	Addendum #1	6-7-2018

ISSUED: CONSTRUCTION DOCUMENTS

DATE: 05/24/2018
SCALE: As indicated
SHEET NAME: GLAZING SCHEDULE

SHEET NUMBER:

A-622

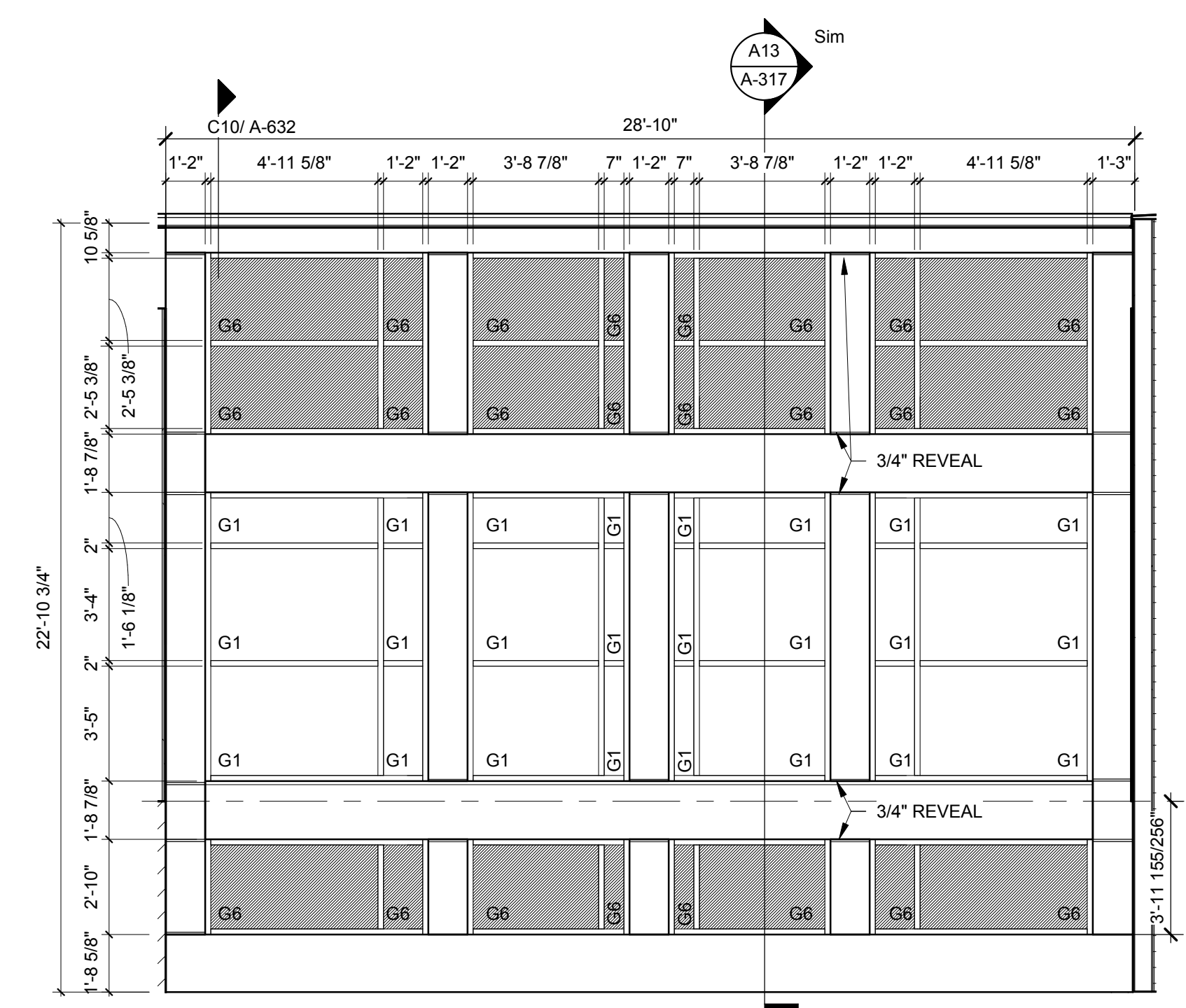

SF Y - RESOURCE ROOM (J4)
1/4" = 1'-0"

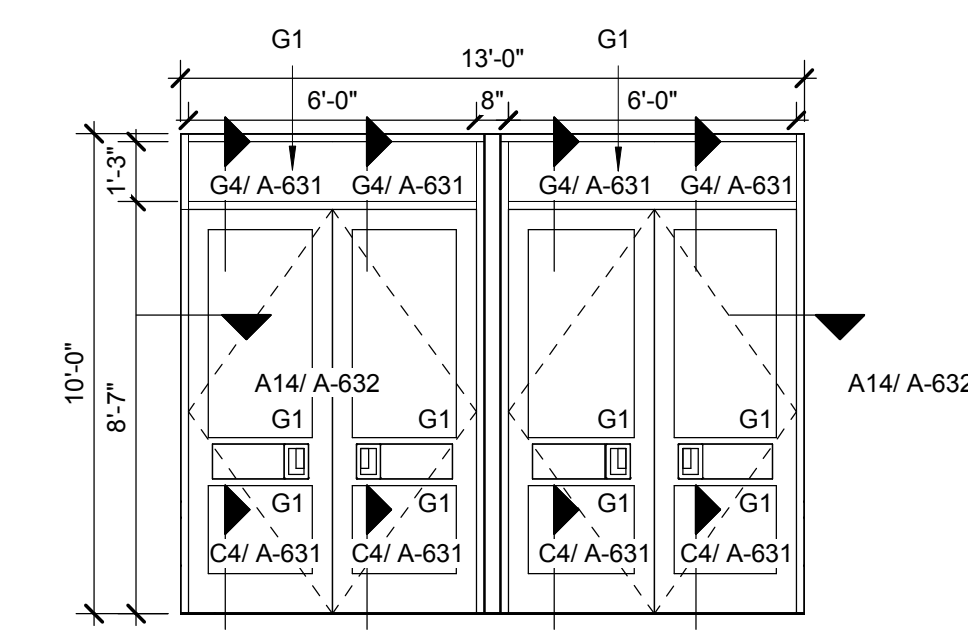

SF W COMMUNITY STAIR (J1)
1/4" = 1'-0"

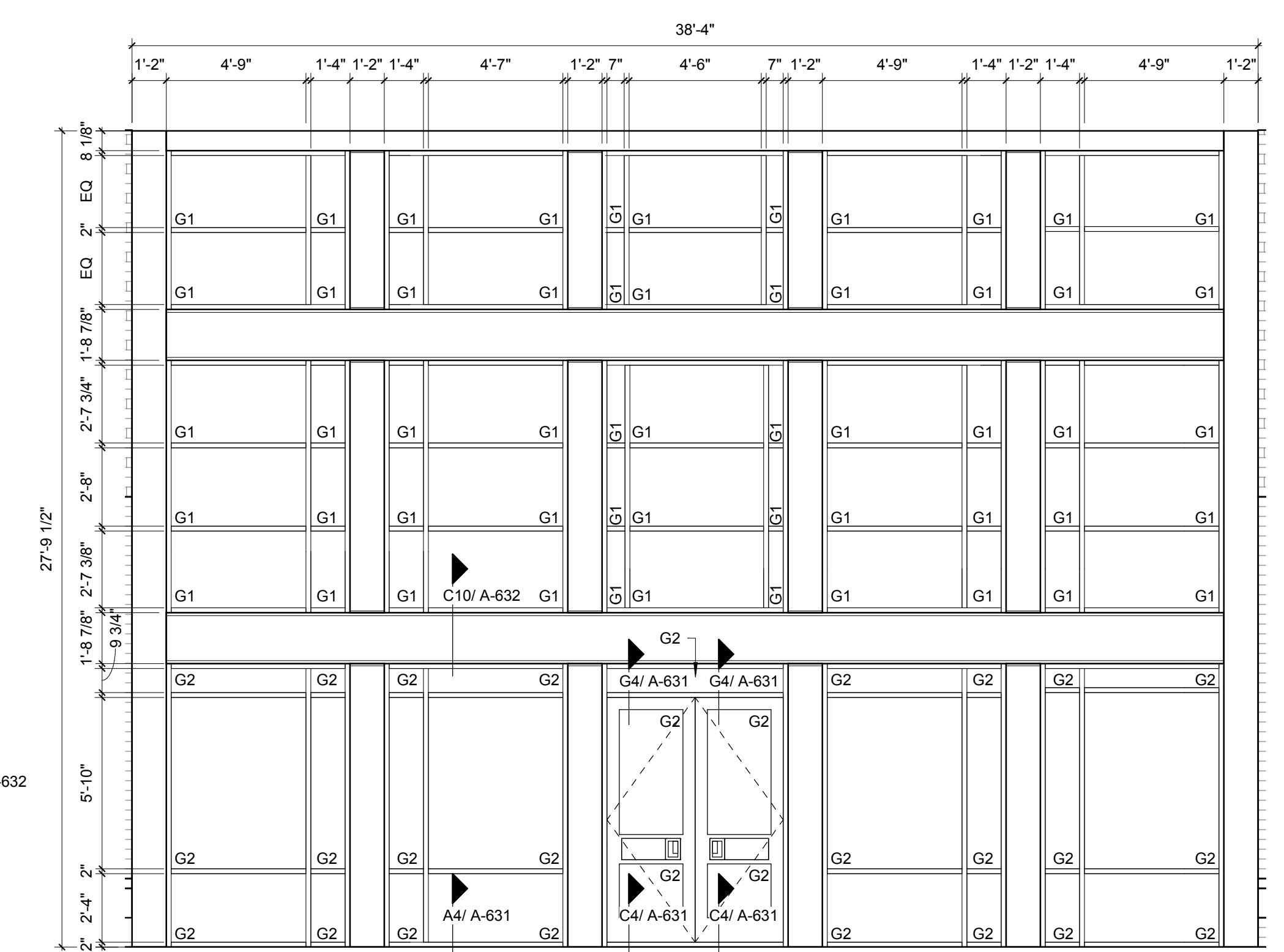

SF T - WEST ENTRY (D1)
1/4" = 1'-0"

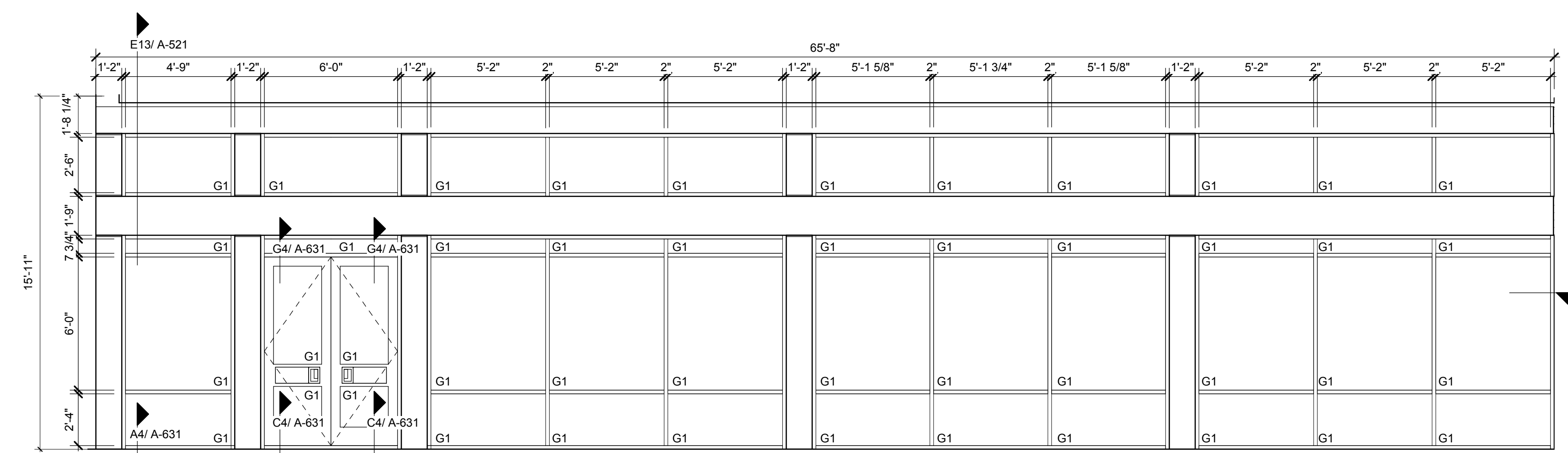

SF U - DINING, SOUTH SIDE (D7)
1/4" = 1'-0"

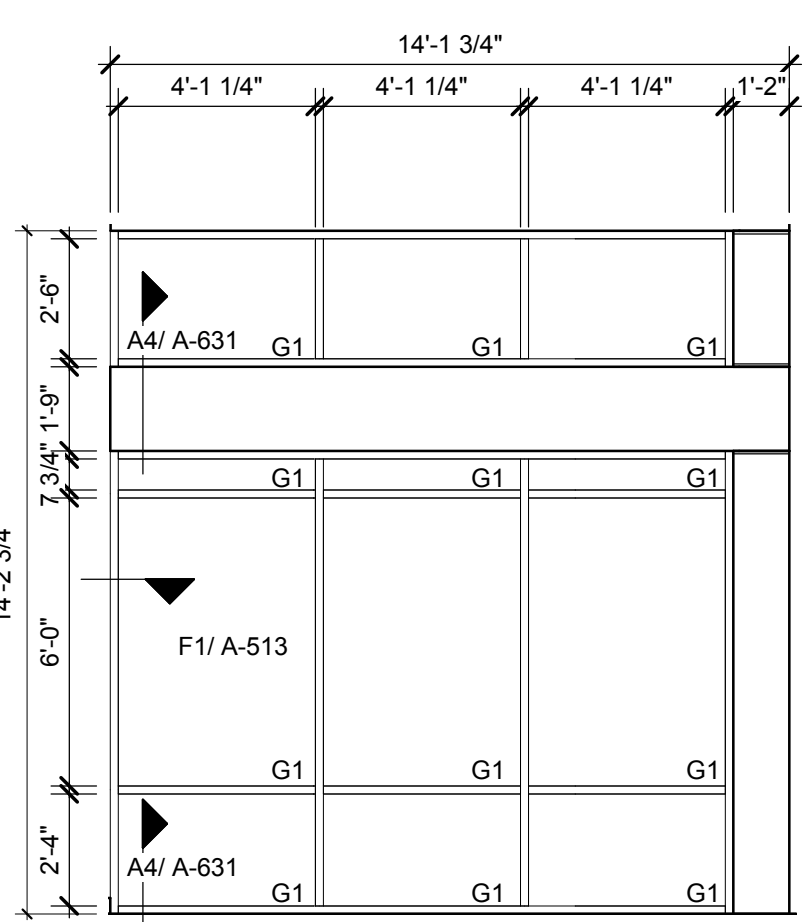

SF V - DINING, W. SIDE (D16)
1/4" = 1'-0"

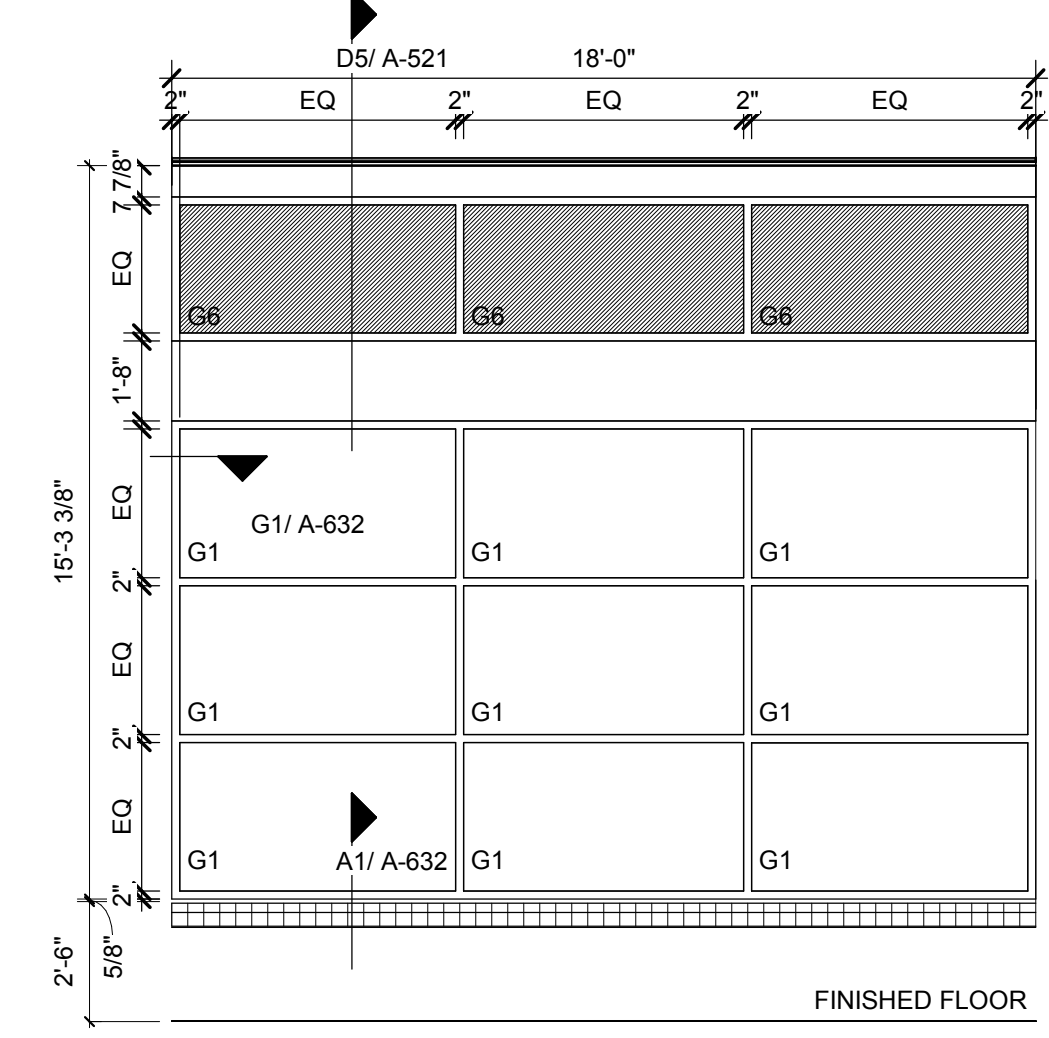

SF S - MUSIC, ART (A16)
1/4" = 1'-0"

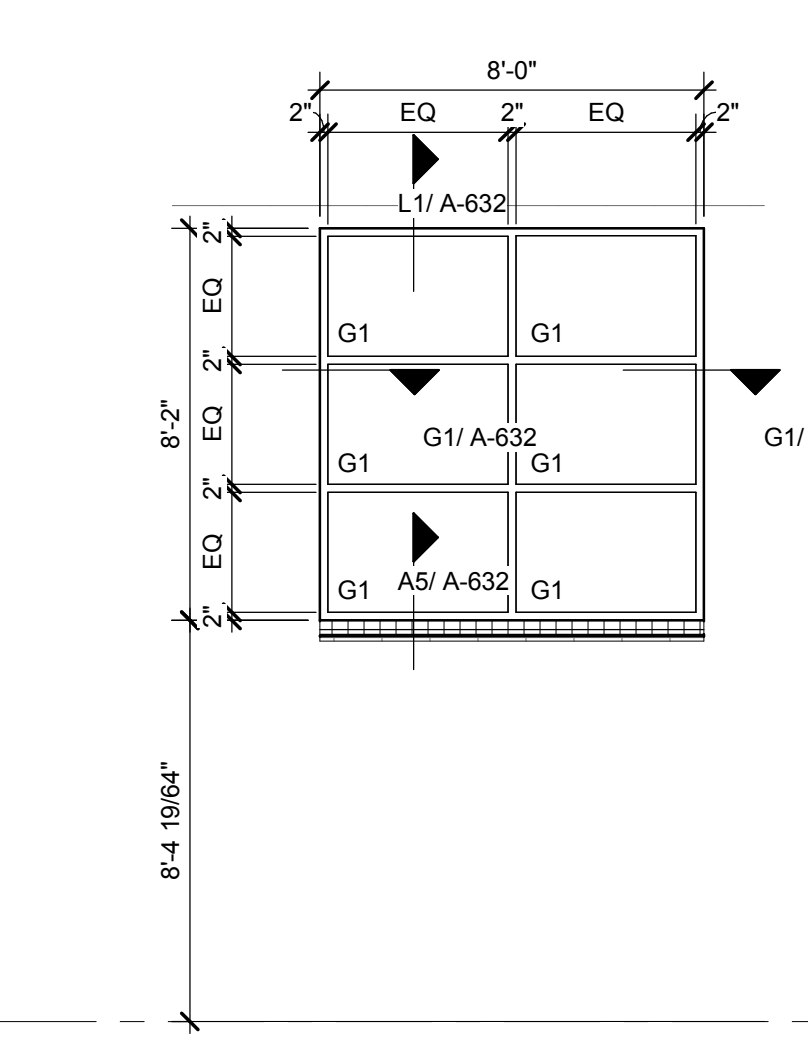

SF R - CLASS 2807 (A13)
1/4" = 1'-0"

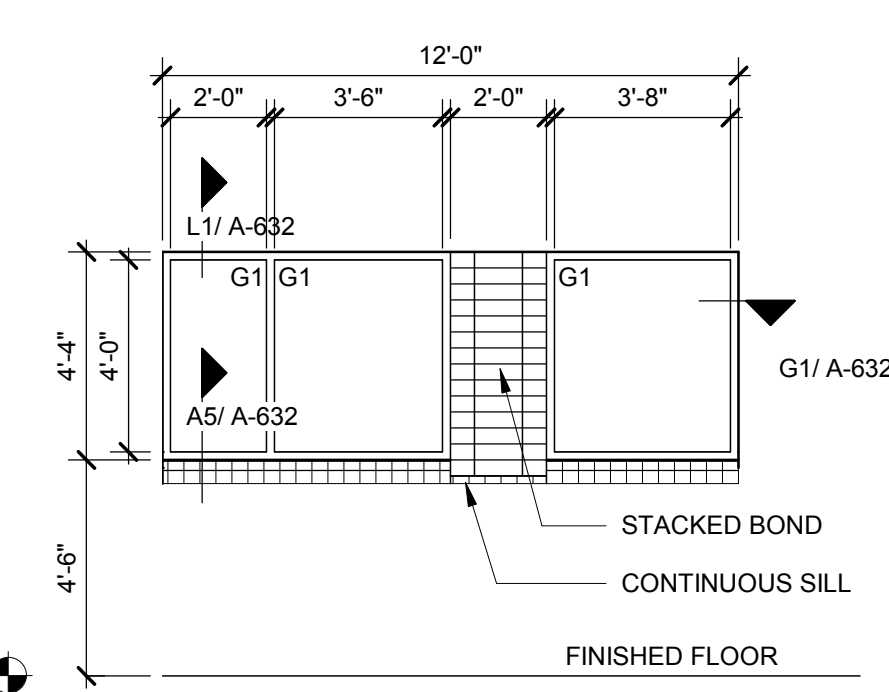

SF Q - LABS (A9)
1/4" = 1'-0"

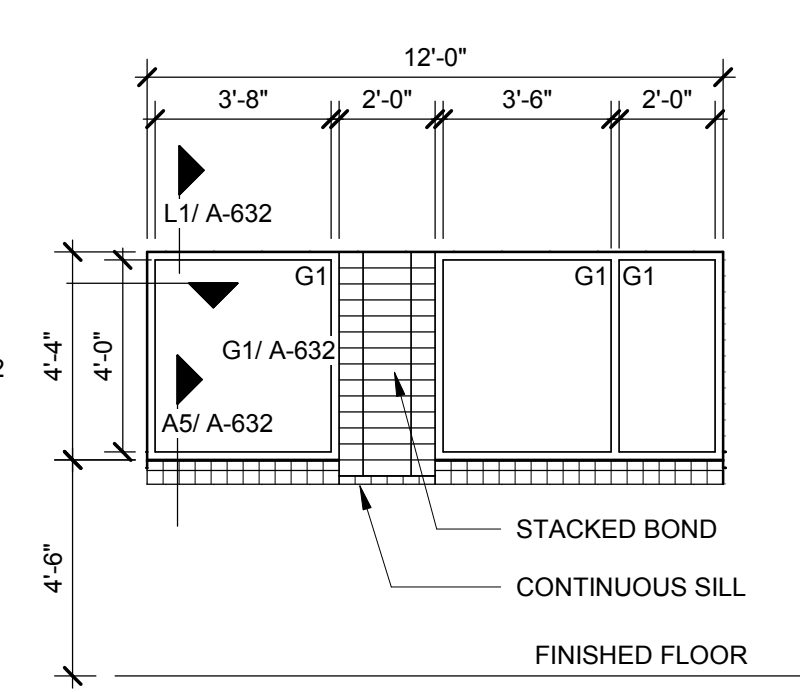

SF P - CLASS WING (A3)
1/4" = 1'-0"

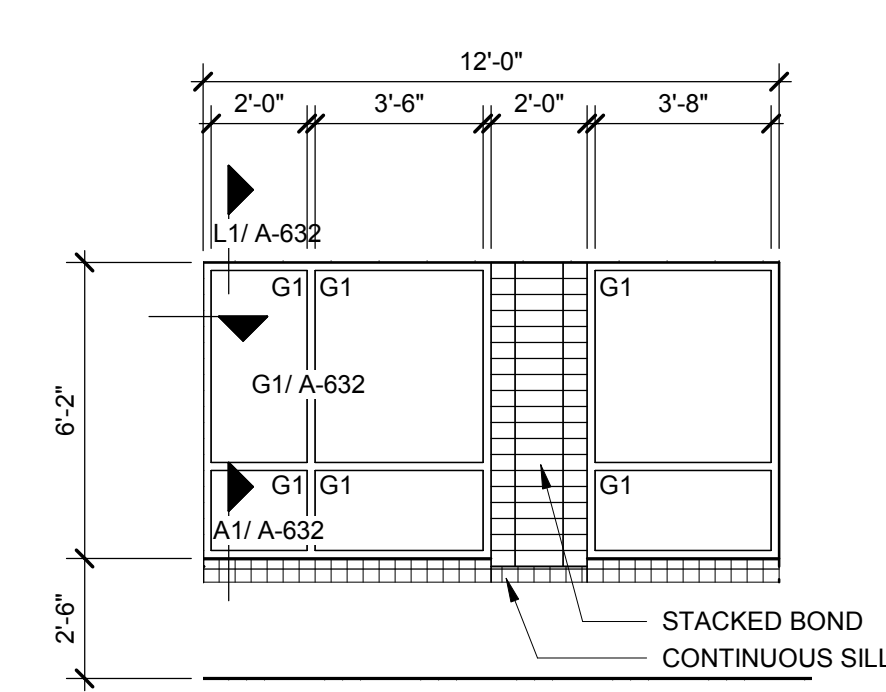

SF N - CLASS WING (A1)
1/4" = 1'-0"