

GENERAL NOTES:

- MECHANICAL EQUIPMENT SHALL NOT BE INSTALLED ABOVE CLASSROOMS.
- FLEXIBLE DUCT RUN OUTS SHALL 3' TO 6' IN LENGTH. DUCT LINING SHALL NOT BE USED.

KEYED NOTES:

- PROVIDE DUCT ACCESS DOOR ON BOTTOM OF DUCT FOR DUCT MOUNTED SMOKE DETECTORS.
- INSTALL AND WIRE DUCT MOUNTED CO2 SENSOR, AND HUMIDITY SENSOR, PROVIDED BY RTU MANUFACTURER.
- INSTALL AND WIRE DUCT MOUNTED TEMPERATURE SENSOR PROVIDED BY RTU MANUFACTURER. WIRE TO CONNECTION POINT ON ZONE THERMOSTAT.
- 36x20 OPENING IN TOP OF DUCT FOR RETURN AIR PATH.
- PROVIDE NECK MOUNTED BALANCE DAMPERS FOR DIFFUSERS.
- 30x16 RETURN OPENING IN TOP OF DUCT.
- 12x12 TRANSFER OPENING IN WALL ABOVE CEILINGS.
- 30x20 TRANSFER OPENING IN WALL ABOVE CEILINGS.
- 4\"/>

- 1-HOUR RATED FIRE BARRIER
- 2-HOUR RATED FIRE BARRIER

THIS LEGEND IS FOR GENERAL REFERENCE ONLY. CONTRACTOR SHALL REFER TO THE LATEST ARCHITECTURAL DRAWINGS FOR EXACT FIRE RATED ASSEMBLY LOCATIONS AND SPECIFICS.

FIRE AND SMOKE WALL LEGEND

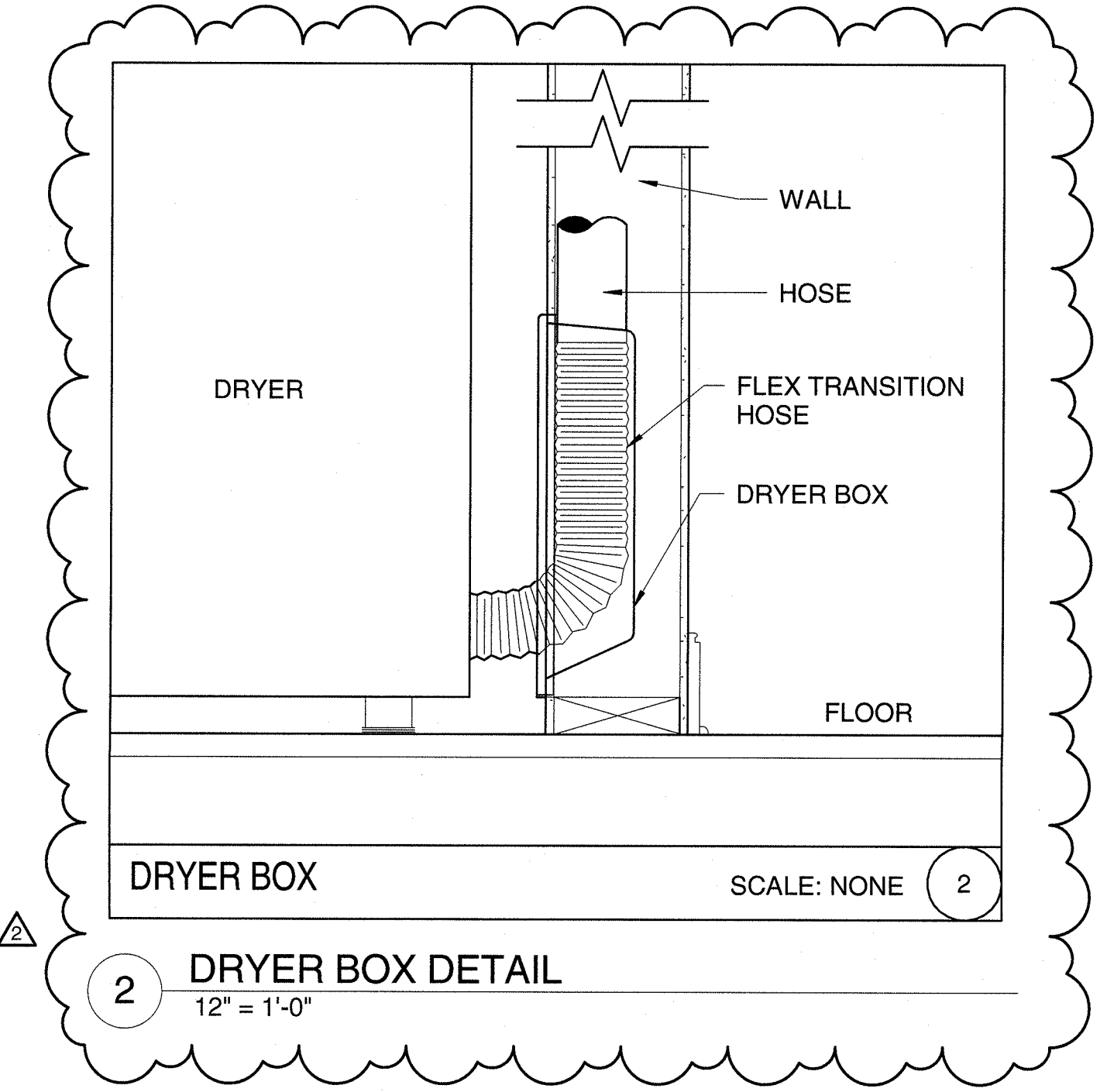

1 DUCTWORK FLOOR PLAN LEVEL 1 - AREA C
1/8" = 1'-0"

ARCHITECT
ksqdesign
NC-ENG-LICENSE NO. C-4064
NEW YORK OKLAHOMA NORTH CAROLINA TEXAS COLORADO SOUTH CAROLINA
KSO Design
1930 CAMDEN ROAD, SUITE 260
CHARLOTTE, NC 28203
704.364.3400 office
704.364.7990 fax
www.ksqdesign.com
Owner
BRUNSWICK COUNTY SCHOOLS
193 SESSIONS DRIVE
BOLIVIA, NC 28422
910.253.2900 office
www.bcschool.net
Civil Engineer
MCGILL ASSOCIATES
715 VILLAGE ROAD SW, SUITE 103
SHALLOTTE, NC 28470
910.755.5872 office
www.mcgillengineer.com
Structural Engineer
CRISER, TROUTMAN, TANNER
3809 PEACHTREE AVE., SUITE 102
WILMINGTON, NC 28403
910.877.2771 office
www.ctengineering.com
MEP Engineer
KSO DESIGN
1930 CAMDEN ROAD, SUITE 260
CHARLOTTE, NC 28203
704.364.3400 office
NC-ENG-LICENSE NO. C-4064
Electrical Consultant
Quality Consulting Engineers, PLLC
6277-600 Carolina Commons Drive, #350
Indian Land SC 29707
Acoustic & Technology Consultant
THORBURN ASSOCIATES
401 N. TYSON STREET, 10TH FLOOR
CHARLOTTE, NC 28202
510.886.7826 office
www.TA-inc.com
Building Envelope Consultant
SKA ENGINEERING
7741 MARKET STREET, SUITE F
WILMINGTON, NC 28411-6444
910.442.2000 office
www.skaeng.com
Food Service Consultant
HERBEN DESIGN
7265 CORN CIRCLE
CHARLOTTE, NC 28212-8914
704.900.0522
www.herben.com

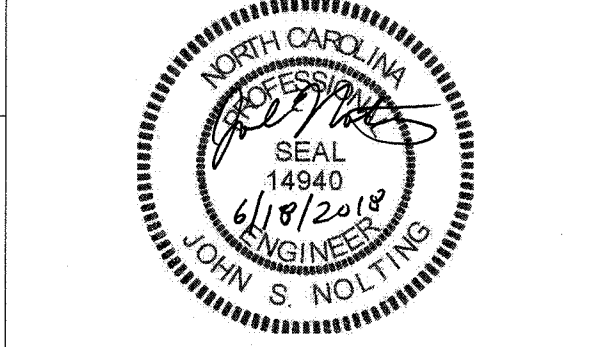

TOWN CREEK MIDDLE SCHOOL

6370 LAKE PARK DRIVE SE
WINNABOW, NC 28479

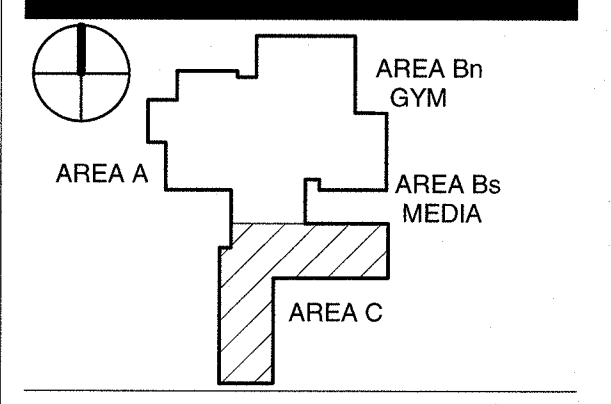

REVISIONS

No.	Description	Date
2	ADDENDUM 2	6/18/2018

ISSUED: CONSTRUCTION DOCUMENTS
DATE: 05/24/2018
SCALE: As indicated
SHEET NAME: DUCTWORK FLOOR PLAN - LEVEL 1 - AREA C
SHEET NUMBER:

M-101C