

- GENERAL NOTES:**
1. MAINTAIN 6 FT MINIMUM BETWEEN ROOF EDGE AND EQUIPMENT REQUIRING SERVICE.
 2. MAINTAIN 10 FT MINIMUM BETWEEN EXHAUST FANS, PLUMBING VENTS, AND OUTSIDE AIR INTAKES. (CLEARANCE IS SHOWN AS DASHED LINE AROUND EXHAUST FANS.)
 3. MAINTAIN MANUFACTURERS RECOMMENDED CLEARANCE AROUND EQUIPMENT FOR SERVICE ACCESS AND FOR AIRFLOW. (SHOWN AS DASHED LINES AROUND RTU'S)

1 Mechanical - Roof Plan - AREA A
1/8" = 1'-0"

ARCHITECT

ksqdesign

NC-ENG-LICENSE NO. C-4064
NEW YORK OKLAHOMA NORTH CAROLINA TEXAS COLORADO SOUTH CAROLINA

KSO Design
1930 CAMDEN ROAD, SUITE 260
CHARLOTTE, NC 28203
704.364.3400 office
704.364.7060 fax
www.ksqdesign.com

Owner
BRUNSWICK COUNTY SCHOOLS
190 SESSIONS DRIVE
BOLIVIA, NC 28422
910.253.2900 office
www.bcsosn.net

Civil Engineer
McGILL ASSOCIATES
712 VILLAGE ROAD SW, SUITE 103
SHALLOTTE, NC 28470
910.755.5872 office
www.mcgillengineer.com

Structural Engineer
CRISER, TROUTMAN, TANNER
3809 PEACHTREE AVE., SUITE 102
WILMINGTON, NC 28403
910.397.2971 office
www.ctengineering.com

MEP Engineer
KSO DESIGN
1930 CAMDEN ROAD, SUITE 260
CHARLOTTE, NC 28203
704.364.3400 office
NC-ENG-LICENSE NO. C-4064

Electrical Consultant
Quality Consulting Engineers, PLLC
6277-600 Carolina Commons Drive, #350
Indian Land SC 29707

Acoustic & Technology Consultant
THORBURN ASSOCIATES
401 N. TYRON STREET, 10TH FLOOR
CHARLOTTE, NC 28202
510.886.7826 office
www.TA-inc.com

Building Envelope Consultant
SKA ENGINEERING
7741 MARKET STREET, SUITE F
WILMINGTON, NC 28411-9444
910.442.2000 office
www.skaeng.com

Food Service Consultant
HERBIN DESIGN
7325 CORN CIRCLE
CHARLOTTE, NC 28212-6914
704.900.0922
www.herbin.com

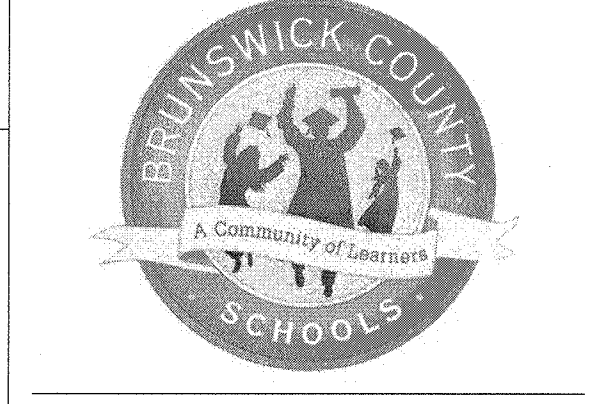
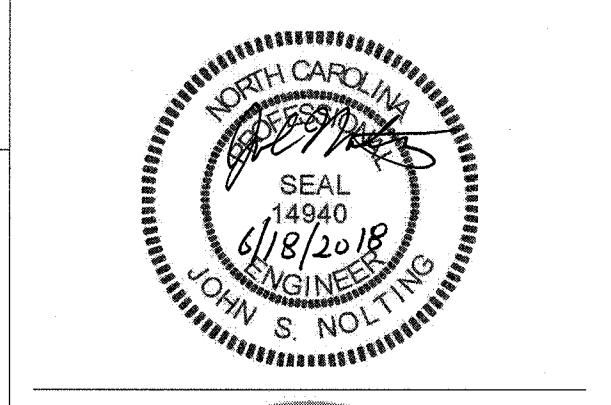

TOWN CREEK MIDDLE SCHOOL

6370 LAKE PARK DRIVE SE
WINNABOW, NC 28479

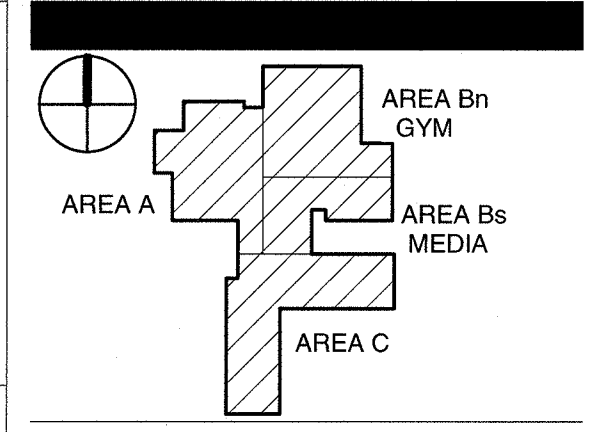

REVISIONS

No.	Description	Date
2	ADDENDUM 2	6/18/2018

ISSUED: CONSTRUCTION DOCUMENTS

DATE: 05/24/2018
SCALE: 1/8" = 1'-0"
SHEET NAME:
MECHANICAL ROOF PLAN - AREA A

SHEET NUMBER:
M-121A