

### GREASE INTERCEPTOR SCHEDULE

SYMBOL	DESCRIPTION	REMARKS
GT-1	ZURN GREEN TURTLE PROCEPTOR GMC 1000 - 1000 GALLON TOTAL WET VOLUME - 577 GALLON GREASE CAPACITY 295 GALLON MAX. SOLIDS CAPACITY CONSTRUCTED OF FIBERGLASS REINFORCED PLASTIC WITH A PVC PIPING ARRANGEMENT AND INTERNAL BAFFLE SEPARATING THE UNIT INTO TWO CHAMBERS. INTERCEPTOR IS LOCATED IN A TRAFFIC AREA AND WILL REQUIRE REINFORCED CONCRETE AND RELIEVING SLAB TO HANDLE TRAFFIC LOADS.	PROVIDE EXTENSIONS AS REQUIRED. INSTALLATION SHALL BE PER THE MANUFACTURER'S INSTALLATION INSTRUCTIONS.
ACCEPTED EQUALS - WATTS ROCKFORD SEPARATOR		
CONTRACTOR SHALL BE RESPONSIBLE FOR PROVIDING THE MODEL WHICH MOST CLOSELY RESEMBLES AND PERFORMS EQUAL TO SPECIFIED PRODUCT. ONLY THE MANUFACTURERS LISTED WILL BE ACCEPTED UNLESS THE PROCEDURES FOR SUBSTITUTION AS INDICATED BY THE SPECIFICATIONS, ARE FOLLOWED.		

### SOLIDS INTERCEPTOR SCHEDULE

SYMBOL	DESCRIPTION	REMARKS
SI-1	ZURN GREEN TURTLE PROCEPTOR SMC 500 - 500 GALLON SOLIDS INTERCEPTOR CONSTRUCTED OF FIBERGLASS REINFORCED PLASTIC WITH A PVC PIPING ARRANGEMENT AND INTERNAL BAFFLE SEPARATING THE UNIT INTO TWO CHAMBERS. INTERCEPTOR IS LOCATED IN A TRAFFIC AREA AND WILL REQUIRE REINFORCED CONCRETE AND RELIEVING SLAB TO HANDLE TRAFFIC LOADS.	PROVIDE EXTENSIONS AS REQUIRED. INSTALLATION SHALL BE PER THE MANUFACTURER'S INSTALLATION INSTRUCTIONS.
ACCEPTED EQUALS - WATTS ROCKFORD SEPARATOR		
CONTRACTOR SHALL BE RESPONSIBLE FOR PROVIDING THE MODEL WHICH MOST CLOSELY RESEMBLES AND PERFORMS EQUAL TO SPECIFIED PRODUCT. ONLY THE MANUFACTURERS LISTED WILL BE ACCEPTED UNLESS THE PROCEDURES FOR SUBSTITUTION AS INDICATED BY THE SPECIFICATIONS, ARE FOLLOWED.		

### BACKFLOW PREVENTER SCHEDULE

SYMBOL	DESCRIPTION	REMARKS
BFP-1	WATTS SERIES 009QT-S REDUCED PRESSURE BACKFLOW PREVENTER. PROVIDE DRAIN FITTING. ASSE 1013 COMPLIANT.	PIPE RELIEF FULL SIZE TO FLOOR DRAIN
ACCEPTED EQUALS - WATTS FEBCO		
COMPLIANCE NOTE: CONTRACTOR SHALL BE RESPONSIBLE FOR PROVIDING THE MODEL WHICH MOST CLOSELY RESEMBLES AND PERFORMS EQUAL TO SPECIFIED PRODUCT. ONLY THE MANUFACTURERS LISTED WILL BE ACCEPTED UNLESS THE PROCEDURES FOR SUBSTITUTION AS INDICATED BY THE SPECIFICATIONS, ARE FOLLOWED.		

### SUMP PUMP SCHEDULE

PUMP	SERVICE	TYPE	CAPACITY		VOLTAGE PHASE AND CYCLES	HORSE POWER	MFG. AND MODEL NO. UNIT IS BASED ON	PUMP CONTROL
			GPM.	HEAD (FEET)				
SP-1	SUMP PUMP	ELEVATOR SUMP PUMP	50	33	115V/1P/60	0.5	STANCOR MODEL SE-50 W/ REMOTE ALARM	SEE DETAIL ON SHEET P-401
ACCEPTED EQUALS - GRUNDOS, LITTLE GIANT								
CONTRACTOR SHALL BE RESPONSIBLE FOR PROVIDING THE MODEL WHICH MOST CLOSELY RESEMBLES AND PERFORMS EQUAL TO SPECIFIED PRODUCT. ONLY THE MANUFACTURERS LISTED WILL BE ACCEPTED UNLESS THE PROCEDURES FOR SUBSTITUTION AS INDICATED BY THE SPECIFICATIONS, ARE FOLLOWED.								

### DOMESTIC WATER BOOSTER PUMP SCHEDULE

PUMP	SERVICE	TYPE	CAPACITY		VOLTAGE PHASE, CYCLE	HP	MFG. & MODEL NO. UNIT IS BASED ON	PUMP LOCATION	NOTES
			G.P.M.	BOOST					
DWBP-1	DOMESTIC BOOSTER PUMP	VARIABLE SPEED	170	48 PSI	480/3/60	7.5 EACH	HYFAB MODEL 875 DUPLEX	MOUNTED IN FIRE PUMP HOUSE PACKAGE	COORDINATE WITH FIRE PUMP HOUSE PACKAGE ORDER. BOOSTER PUMP TO BE PART OF FIRE PUMP PACKAGE
ACCEPTED EQUALS - BELL & GOSSETT, GOULDS, ITT									
CONTRACTOR SHALL BE RESPONSIBLE FOR PROVIDING THE MODEL WHICH MOST CLOSELY RESEMBLES AND PERFORMS EQUAL TO SPECIFIED PRODUCT. ONLY THE MANUFACTURERS LISTED WILL BE ACCEPTED UNLESS THE PROCEDURES FOR SUBSTITUTION AS INDICATED BY THE SPECIFICATIONS, ARE FOLLOWED.									

### ROOF HYDRANT

SYMBOL	DESCRIPTION
EPRH-1	MAPA PRODUCTS MPH-24FP-24/9 PEDESTAL HYDRANT WITH 1" BRONZE VALVE WITHIN A FULLY INSULATED STAINLESS STEEL SHROUD. THE DRAIN DOWN OPERATES ON A VENTURI PRINCIPLE WHICH DRAINS TO AN INTEGRAL RESERVOIR TANK BELOW THE ROOF LINE. ONCE HYDRANT IS TURNED BACK ON THE RESERVOIR IS EVACUATED OUT THROUGH THE HYDRANT.
ACCEPTED EQUALS - JOSAM, J.R. SMITH, MIFAB	
CONTRACTOR SHALL BE RESPONSIBLE FOR PROVIDING THE MODEL WHICH MOST CLOSELY RESEMBLES AND PERFORMS EQUAL TO SPECIFIED PRODUCT. ONLY THE MANUFACTURERS LISTED WILL BE ACCEPTED UNLESS THE PROCEDURES FOR SUBSTITUTION AS INDICATED BY THE SPECIFICATIONS, ARE FOLLOWED.	

### THERMOSTATIC MIXING VALVE SCHEDULE

SYMBOL	REQUIRED GPM	PRESSURE DROP	MFG. AND MODEL NO.	MIXED OUTLET	HOT INLET	COLD INLET	FLOW RANGE GPM	REMARKS
MV-1	35 GPM	10	SYMMONS-THERMOSTATIC-MIXER 7-500-102-PRV	1-1/4"	1"	1"	GPM @ 5MIN - (38.0)MAX	SET TO DELIVER 110° HW INCOMING TEMP TO VALVE 140°.
ACCEPTED EQUALS - SYMMONS, LAWLER, ARMSTRONG								
CONTRACTOR SHALL BE RESPONSIBLE FOR PROVIDING THE MODEL WHICH MOST CLOSELY RESEMBLES AND PERFORMS EQUAL TO SPECIFIED PRODUCT. ONLY THE MANUFACTURERS LISTED WILL BE ACCEPTED UNLESS THE PROCEDURES FOR SUBSTITUTION AS INDICATED BY THE SPECIFICATIONS, ARE FOLLOWED.								

### GAS FIRED WATER HEATER SCHEDULE

HEATER	STORAGE CAPACITY (GALLONS)	RECOVERY @ 70° RISE (G.P.H.)	NATURAL GAS INPUT (BTUH)	MFG. AND MODEL NO. UNIT IS BASED ON	LOCATION	REMARKS
GWH-1	100	235	199,900 BTUH	AO SMITH CYCLONE MXI BTH-199 CONDENSING HEATER - DIRECT VENT/INTAKE	PLUMBING 1311	INSTALL PER MANUFACTURERS SPECIFICATIONS. MECHANICAL CONTRACTOR TO PROVIDE EXHAUST/INTAKE ROUTING AND CONNECTION. SEE MECHANICAL PLANS.
GWH-2	60	RECOVERY @ 70° RISE (G.P.H.) 197	120,000 BTUH	AO SMITH CYCLONE MXI BTH-120 CONDENSING HEATER - DIRECT VENT/INTAKE	STORAGE 1209	INSTALL PER MANUFACTURERS SPECIFICATIONS. MECHANICAL CONTRACTOR TO PROVIDE EXHAUST/INTAKE ROUTING AND CONNECTION. SEE MECHANICAL PLANS.
GWH-3	100	RECOVERY @ 70° RISE (G.P.H.) 255	150,000 BTUH	AO SMITH CYCLONE MXI BTH-150 CONDENSING HEATER - DIRECT VENT/INTAKE	CUSTODIAN WORKROOM 1826	INSTALL PER MANUFACTURERS SPECIFICATIONS. MECHANICAL CONTRACTOR TO PROVIDE EXHAUST/INTAKE ROUTING AND CONNECTION. SEE MECHANICAL PLANS.
GWH-4	119	RECOVERY @ 70° RISE (G.P.H.) 658	399,900 BTUH	AO SMITH CYCLONE MXI BTH-400 CONDENSING HEATER - DIRECT VENT/INTAKE	JANITOR 1707	INSTALL PER MANUFACTURERS SPECIFICATIONS. MECHANICAL CONTRACTOR TO PROVIDE EXHAUST/INTAKE ROUTING AND CONNECTION. SEE MECHANICAL PLANS.
GWH-5	119	RECOVERY @ 70° RISE (G.P.H.) 658	399,900 BTUH	AO SMITH CYCLONE MXI BTH-400 CONDENSING HEATER - DIRECT VENT/INTAKE	JANITOR 2914	INSTALL PER MANUFACTURERS SPECIFICATIONS. MECHANICAL CONTRACTOR TO PROVIDE EXHAUST/INTAKE ROUTING AND CONNECTION. SEE MECHANICAL PLANS.
ACCEPTED EQUALS - RHEEM, STATE, LOCHINVAR						
CONTRACTOR SHALL BE RESPONSIBLE FOR PROVIDING THE MODEL WHICH MOST CLOSELY RESEMBLES AND PERFORMS EQUAL TO SPECIFIED PRODUCT. ONLY THE MANUFACTURERS LISTED WILL BE ACCEPTED UNLESS THE PROCEDURES FOR SUBSTITUTION AS INDICATED BY THE SPECIFICATIONS, ARE FOLLOWED.						

### EXPANSION TANK SCHEDULE

SYMBOL	LOCATION	NO. OF TANKS	TANK VOLUME	DIMENSION (INCHES)	MINIMUM OPERATING PRESSURE	MFG. AND MODEL NO.
EX-1	AT WATER HEATER	1	6.4 GAL.	12"Dx18"H	50	AMTROL THERM-X-TROL MODEL ST-12-C
EX-2	AT WATER HEATER	1	2.0 GAL.	8"Dx14"H	50	AMTROL THERM-X-TROL MODEL ST-5-C
EX-3	AT WATER HEATER	1	2.0 GAL.	8"Dx14"H	50	AMTROL THERM-X-TROL MODEL ST-5-C
EX-4	AT WATER HEATER	1	2.0 GAL.	8"Dx14"H	50	AMTROL THERM-X-TROL MODEL ST-5-C
EX-5	AT WATER HEATER	1	2.0 GAL.	8"Dx14"H	50	AMTROL THERM-X-TROL MODEL ST-5-C
ACCEPTED EQUALS - WATTS, B&G, BRADFORD-WHITE						
CONTRACTOR SHALL BE RESPONSIBLE FOR PROVIDING THE MODEL WHICH MOST CLOSELY RESEMBLES AND PERFORMS EQUAL TO SPECIFIED PRODUCT. ONLY THE MANUFACTURERS LISTED WILL BE ACCEPTED UNLESS THE PROCEDURES FOR SUBSTITUTION AS INDICATED BY THE SPECIFICATIONS, ARE FOLLOWED.						

### INSTANTANEOUS ELECTRIC WATER HEATER SCHEDULE

HEATER	TEMPERATURE RISE AT GPM	ELECTRICAL REQUIREMENTS	MFG. AND MODEL NO. UNIT IS BASED ON	LOCATION	REMARKS
EWH-1	56 DEG F @ 0.5 GPM TURN ON 0.3 GPM	277 V / 1PH / 60 HZ 4.1 KW 15 AMPS	EEMAX MODEL EX4277	TOILET 1206B TOILET 1208B	ENSURE INSTALLATION OF 0.5 GPM OUTLET INTEGRAL WITH INSTALLED FAUCET
EWH-2	46 DEG F @ 1.5 GPM TURN ON 0.9 GPM	277 V / 1PH / 60 HZ 10 KW 38 AMPS	EEMAX MODEL EX100 SL	ART 1413	ENSURE INSTALLATION OF 1.5 GPM OUTLET INTEGRAL WITH INSTALLED FAUCET
ACCEPTED EQUALS - RHEEM, STATE, LOCHINVAR					
CONTRACTOR SHALL BE RESPONSIBLE FOR PROVIDING THE MODEL WHICH MOST CLOSELY RESEMBLES AND PERFORMS EQUAL TO SPECIFIED PRODUCT. ONLY THE MANUFACTURERS LISTED WILL BE ACCEPTED UNLESS THE PROCEDURES FOR SUBSTITUTION AS INDICATED BY THE SPECIFICATIONS, ARE FOLLOWED.					

### BALANCING VALVE ASSEMBLY

SYMBOL	DESCRIPTION
BVA-1	BELL AND GOSSETT - CIRCUIT SETTER PLUS - MODEL MC, BRASS CONSTRUCTION EPDM "O" RINGS. TWO PRESSURE AND TEMPERATURE MEASURING POINTS. CALIBRATED BALANCING UNIT WITH POSITIVE SHUT-OFF. UNIT SHALL BE MOUNTED IN A ACCESSIBLE LOCATION.
CONTRACTOR SHALL BE RESPONSIBLE FOR PROVIDING THE MODEL WHICH MOST CLOSELY RESEMBLES AND PERFORMS EQUAL TO SPECIFIED PRODUCT. ONLY THE MANUFACTURERS LISTED WILL BE ACCEPTED UNLESS THE PROCEDURES FOR SUBSTITUTION AS INDICATED BY THE SPECIFICATIONS, ARE FOLLOWED.	

### CLEANOUT SCHEDULE

SYMBOL	DESCRIPTION
WCO	JAY R. SMITH 4530 CLEANOUT TEE. DURA-COATED CAST IRON BODY, NO-HUB CONNECTION, GAS AND WATERTIGHT TAPERED THREADED ABS PLUG AND SMOOTH STAINLESS STEEL WALL ACCESS COVER. LOCATE 24" OR LESS ABOVE FINISHED FLOOR UNLESS OTHERWISE NOTED.
FCO	JAY R. SMITH MODEL 4020 CLEANOUT, DURA-COATED CAST IRON BODY, HUB CONNECTION, GAS AND WATERTIGHT TAPERED THREADED ABS PLUG AND ROUND SCORATED NICKEL BRONZE TOP.
ACCEPTED EQUALS - JOSAM, ZURN, MIFAB	



NC-ENG-LICENSE NO. C-4054  
NEW YORK OKLAHOMA NORTH CAROLINA TEXAS COLORADO SOUTH CAROLINA

**KSQ Design**  
1930 CAMDEN ROAD, SUITE 260  
CHARLOTTE, NC 28203  
704.364.3400 office  
704.364.7880 fax  
www.ksqdesign.com

**Owner**  
**BRUNSWICK COUNTY SCHOOLS**  
199 SESSIONS DRIVE  
BOLIVIA, NC 28422  
910.253.2900 office  
www.bcschools.net

**Civil Engineer**  
MCGILL ASSOCIATES  
712 VILLAGE ROAD SW, SUITE 103  
SHALLOTTE, NC 28470  
910.755.5872 office  
www.mcgillassociates.com

**Structural Engineer**  
CRISER, TROUTMAN, TANNER  
3809 PEACHTREE AVE., SUITE 102  
WILMINGTON, NC 28403  
910.397.2971 office  
www.ctengineering.com

**MEP Engineer**  
KSQ DESIGN  
1930 CAMDEN ROAD, SUITE 260  
CHARLOTTE, NC 28203  
704.364.3400 office  
www.ksqdesign.com

**Electrical Consultant**  
Quality Consulting Engineers, PLLC  
6277-600 Carolina Commons Drive, #350  
Indian Land SC 29107

**Acoustic & Technology Consultant**  
THORBJURN ASSOCIATES  
401 N. TRYON STREET, 10TH FLOOR  
CHARLOTTE, NC 28202  
910.886.7826 office  
www.TA-inc.com

**Building Envelope Consultant**  
SKA ENGINEERING  
7741 MARKET STREET, SUITE F  
WILMINGTON, NC 28411-8444  
910.442.2000 office  
www.skaeng.com

**Food Service Consultant**  
HERBIN DESIGN  
7255 DORR CIRCLE  
CHARLOTTE, NC 28212-8914  
704.900.0522  
www.herbin.com

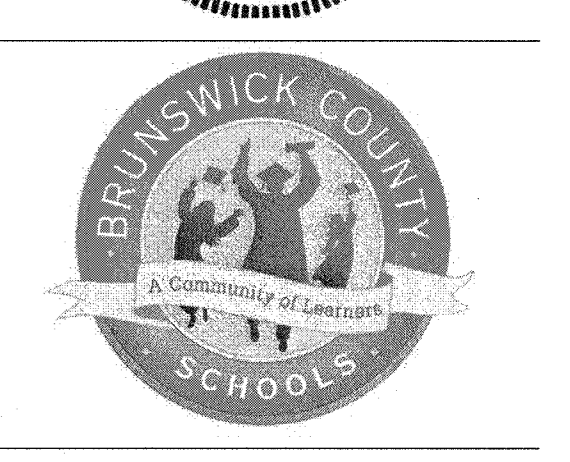
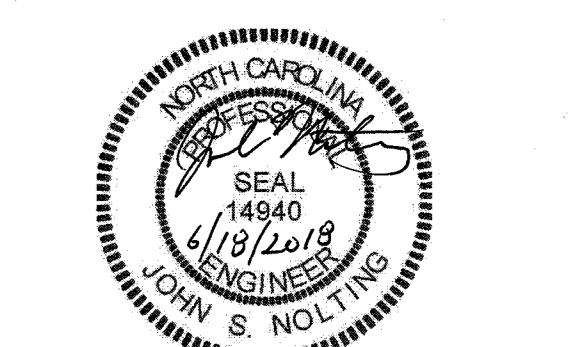
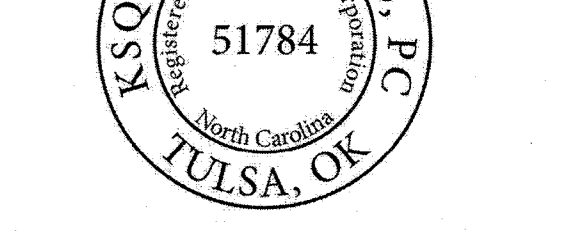

## TOWN CREEK MIDDLE SCHOOL

6370 LAKE PARK DRIVE SE  
WINNABOW, NC 28479

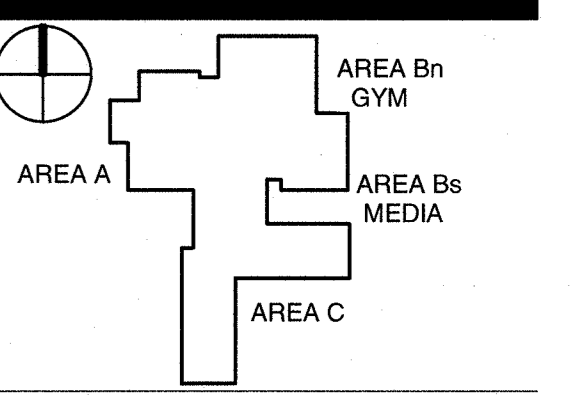

No.	Description	Date
2	ADDENDUM 2	6/18/2018

**ISSUED: CONSTRUCTION DOCUMENTS**

**DATE:** 05/24/2018  
**SCALE:** 12" = 1'-0"  
**SHEET NAME:** PLUMBING SCHEDULES

**SHEET NUMBER:**